

Fashion

CUSTOM VENTILATED AWNINGS

FASHION AWNINGS offer you a variety of styles. They are priced differently, they are designed differently both from appearance and from the purpose for which they are to be used. Each customer has a little different idea of what appeals to him. With FASHION AWNINGS, you have a style to appeal to these differing tastes, and you can fit every type of opening on a home, office or store.



DOORHOODS - It is strictly a matter of personal taste as to which style you or your customer select. Lack of door or head clearance sometimes dictate the type doorhood that has to be used. Width and projection will be determined by covers desired.

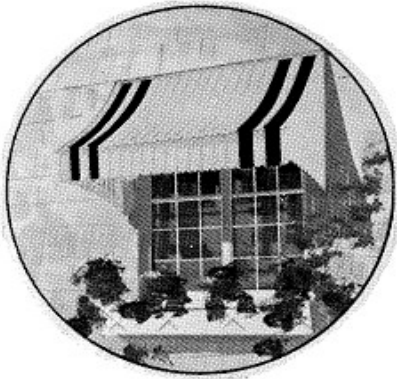

BV SERIES - This series is desirable for all types of windows. The BVR gives maximum protection - the BVS gives more view with less protection. The BV series is ideal for picture window and commercial installations.

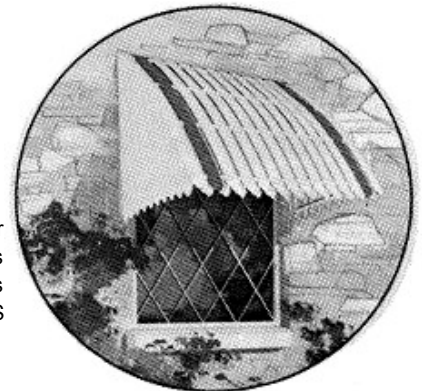

CR SERIES - This style is equally used for single and double hung windows. The CR series provide the most protection - the CS series provide less protection but more view. The CS series is excellent for casement windows.



BR SERIES - This style is equally used for single and double hung windows. The BR series provide the most protection - the BS series provide less protection but more view. The BS series is excellent for porch awnings.

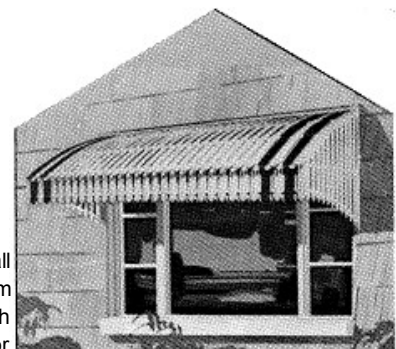

CV SERIES - This series is desirable for all types of windows. The CVR gives maximum protection - the CVS gives more view with less protection. The CV series is ideal for picture window and commercial installations.

VENTILATED AWNINGS AND DOORHOODS

GENERAL INFORMATION

INSTALLATION

All awnings and doorhoods are pre-assembled and shipped in three pieces, ends and top. All Ventilated Awnings wider than 108" are shipped in two or more sections, depending on the overall Width. The awning is assembled on the ground, the female section of the hanging rail is installed on the house. The male section, which comes installed on the awning, can then be snapped into the female section on the house by raising the awning in an upright position and then lowering to the installed position. (IMPORTANT NOTE: If the Ventilated Awning is installed on a building which is uneven, the female section of the hanging rail should be left loose until the awning is snapped into position and then the installation screws tightened securely to the building.) To complete installation, fasten the end wings to the house. Spliced awnings of necessity may need to be put up in sections, utilizing the mullion braces supplied with each awning.

MULLION BRACES

Adequate mullion braces are shipped for proper support (one approximately every 45"). (See below) If additional mullion braces are required, they may be ordered separately: see Repair Parts Price List.

VALANCES

"VENTILATED" Awnings ----- DX, CVR, CVS, BVR, BVS Models only -----will have double valances and be striped to match the top section of the awning. D and DA valances will be single valances and will not be striped.

HAT SECTION BRACING

On extra wide installations, it may be necessary to order all steel hat section to run the horizontal width of the awning if the regular number of mullion braces cannot be spaced as recommended. On awnings wider than 72" an extra cross rail is placed in all awnings. The hat section may then be attached to the double rail using a #8 x 1/2" self drilling fastener screw through the hat section and into the rails. The mull brace may then be attached to the hat section. (See Below) Hat section bracing must be ordered extra. It is not shipped as part of standard packaged awning. An additional charge per width foot of awning must be added.

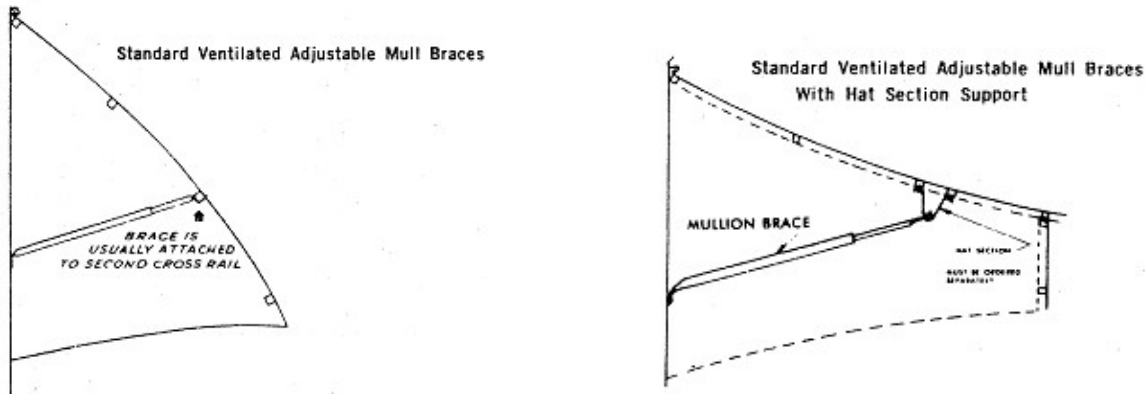

SELECTION AND MEASURING OF FASHION VENTILATED AWNINGS

When you start to measure for a FASHION Awning there are 3 major points to remember: ---(The examples listed are for the "VENTILATED" series.

1. STYLE? You must select the style of awning to be used before you determine the Model Number, Width, slat length and projection.
2. WIDTH? Width of awning is one of the most important considerations. These points should be Remembered:
 - a. Frame Homes – These windows usually have a 4" window facing. Measure from the outside edge of the facing as the maximum width of your awning. Drop back to the next size width in the price list --- for example: if the distance between the outside edges of the facing is 46" drop back to 43 1/2" width. If it should be 51" drop back to a 49" width.
 - b. Masonry Homes-----You should measure the width of the opening (from brick to brick) add 3" minimum on each side (total 6") and use the next largest size awning. For example: if the window opening is 36" add 6" which makes your measurement 42" --- you would select the next size which is a 43 1/2".

- c. Doorhoods ---- Do not hang the doorhood on the door facing. Make your doorhood at least 8" wider than the door facing or a minimum of at least 16" wider than the door. The doorhood **MUST BE HUNG HIGH ENOUGH** to give the minimum clearance necessary for the door to open.
3. POINT DROP? The point drop of any model awning should be enough to provide proper shade for the exposed window area. The shorter the projection, the greater the point drop should be. And, the greater the projection, the higher point drop is adequate. (See Illustration.)

SPECIAL ENDS

Special Ends may be used on any Fashion Awning so long as standard tops and valances are used. A nominal pattern charge will be incurred per pair extra. The regular cost of ends cannot be deducted. Fashion can and will manufacture any awning END (or wing) you can design, measure or draw (of course, they must be geometrically sound). For unusual cut-outs, it is desirable to cut cardboard to fit the building exactly, and send the cardboard or transposed drawing to us.

Give awning top enough drop so that it will not have a "Water Pocket". Give Doorhoods proper drop for Door Clearance and Head Clearance. If Doorhoods can be installed on an overhang of a home, a much shorter top can be used, thus, cutting the cost considerably. The illustrations below are only a very few suggested SPECIAL ENDS. Make your own drawings to fit unusual problems, but use **ONLY** standard tops.

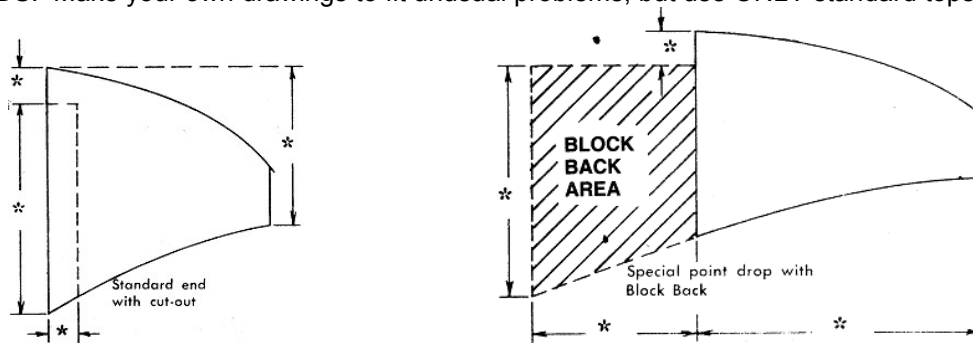

SPECIAL WIDTHS

Fashion Awnings are fabricated in special built jigs; therefore, you should order the standard widths from this price book. For special installations, such a fitting between brick walls, Fashion Ventilated Awnings may be reduced 1" to 2" by removing the end slats from both ends and cutting off each end of the cross rail one-half the needed reduction, and then reinstall the end slats, moving them closer together. However, if you prefer, Ventilated Awnings may be ordered to an exact width for a nominal charge per awning extra. Fashion Ventilated Awnings are now built on 1/2" space between slats to reduce the possibility of any rain or sun coming thru the awning top. Awnings measured too narrow can be widened by adding slats and rails to the ends of an awning. [The necessary materials for making these splices are available under Repair Parts Price list for Ventilated Awnings.]

COLOR INFORMATION FOR VENTILATED AWNINGS AND DOORHOODS

BASE COLORS

Colors are available in solid white or any of duo-tone colors shown below. On duo-tone awnings, the top side of the slat will be the selected color and the underside, white. The entire understructure will be white. All cross-rails in the awning top and the ends will be white, regardless of the outside color.

TRIM COLOR

You have a choice of trim colors as shown below. Standard trim will consist of two trim slats, second slat from each end. Four trim slats, [second and fourth trim slat from awning end], may be ordered at no extra charge.

VENTILATED ALUMINUM BASE AND TRIM COLORS

#10 WHITE
#50 BLACK
#12 IVORY

#61 EMERALD GREEN
#15 SANDLEWOOD

#17 ANTIQUE BROWN
#46 BRICK RED

DX INCREMENTAL WIDTH CHART

ADD'L CHRGs	WIDTH	MODEL PREFIX #	ADD'L CHRGs	WIDTH	MODEL PREFIX #	ADD'L CHRGs	WIDTH	MODEL PREFIX #	ADD'L CHRGs	WIDTH	MODEL PREFIX #
0	127	127	21	179 1/2	180	42	232	232	63	284 1/2	285
1	129 1/2	130	22	182	182	43	234 1/2	235	64	287	287
2	132	132	23	184 1/2	185	44	237	237	65	289 1/2	290
3	134 1/2	135	24	187	187	45	239 1/2	240	66	292	292
4	137	137	25	189 1/2	190	46	242	242	67	294 1/2	295
5	139 1/2	140	26	192	192	47	244 1/2	245	68	297	297
6	142	142	27	194 1/2	195	48	247	247	69	299 1/2	300
7	144 1/2	145	28	197	197	49	249 1/2	250	70	302	302
8	147	147	29	199 1/2	200	50	252	252	71	304 1/2	305
9	149 1/2	150	30	202	202	51	254 1/2	255	72	307	307
10	152	152	31	204 1/2	205	52	257	257	73	309 1/2	310
11	154 1/2	155	32	207	207	53	259 1/2	260	74	312	312
12	157	157	33	209 1/2	210	54	262	262	75	314 1/2	315
13	159 1/2	160	34	212	212	55	264 1/2	265	76	317	317
14	162	162	35	214 1/2	215	56	267	267	77	319 1/2	320
15	164 1/2	165	36	217	217	57	269 1/2	270	78	322	322
16	167	167	37	219 1/2	220	58	272	272	79	324 1/2	325
17	169 1/2	170	38	222	222	59	274 1/2	275	80	327	327
18	172	172	39	224 1/2	225	60	277	277	81	329 1/2	330
19	174 1/2	175	40	227	227	61	279 1/2	280	82	332	332
20	177	177	41	229 1/2	230	62	282	282	83	334 1/2	335

Example : A DX 175 53 [174 1/2" wide w/53" slats] would be priced as below

DX 127 53 - base price from cost sheet =	aaa.aa
19 add'l increments @ \$ x.xx =	<u>bbb.bb</u>
DX 175 53 Book price =	ccc.cc

D & DA INCREMENTAL WIDTH CHART

ADD'L CHRGs	WIDTH	MODEL PREFIX #	ADD'L CHRGs	WIDTH	MODEL PREFIX #	ADD'L CHRGs	WIDTH	MODEL PREFIX #	ADD'L CHRGs	WIDTH	MODEL PREFIX #
0	137 13/16	138	21	202 1/8	202	42	266 7/16	266	63	330 3/4	331
1	140 7/8	141	22	205 3/16	205	43	269 1/2	269	64	333 13/16	334
2	143 15/16	144	23	208 1/4	208	44	272 9/16	273	65	336 7/8	337
3	147	147	24	211 5/16	211	45	275 5/8	276	66	339 15/16	340
4	150 1/16	150	25	214 3/8	214	46	278 11/16	279	67	343	343
5	153 1/8	153	26	217 7/16	217	47	281 3/4	282	68	346 1/16	346
6	156 3/16	156	27	220 1/2	220	48	284 13/16	285	69	349 1/8	349
7	159 1/4	159	28	223 9/16	224	49	287 7/8	288	70	352 3/16	352
8	162 5/16	162	29	226 5/8	227	50	290 15/16	291	71	355 1/4	355
9	165 3/8	165	30	229 11/16	230	51	294	294	72	358 5/16	358
10	168 7/16	168	31	232 3/4	233	52	297 1/16	297	73	361 3/8	361
11	171 1/2	171	32	235 13/16	236	53	300 1/8	300	74	364 7/16	364
12	174 9/16	175	33	238 7/8	239	54	303 3/16	303	75	367 1/2	367
13	177 5/8	178	34	241 15/16	242	55	306 1/4	306	76	370 9/16	371
14	180 11/16	181	35	245	245	56	309 5/16	309	77	373 5/8	374
15	183 3/4	184	36	248 1/16	248	57	312 3/8	312	78	376 11/16	377
16	186 13/16	187	37	251 1/8	251	58	315 7/16	315	79	379 3/4	380
17	189 7/8	190	38	254 3/16	254	59	318 1/2	318	80	382 13/16	383
18	192 15/16	193	39	257 1/4	257	60	321 9/16	322	81	385 7/8	386
19	196	196	40	260 5/16	260	61	324 5/8	325	82	388 15/16	389
20	199 1/16	199	41	263 3/8	263	62	327 11/16	328	83	392	392

SOLID AND VENTILATED DOORHOODS
D-DX-DA SERIES

8/15/2009

D 45 (SOLID TOP)			D 53 (SOLID TOP)			DX 45 (VENTILATED)			DX 53 (VENTILATED)			DA 45 (SOLID TOP)		
45		SLAT LENGTH	53			45		SLAT LENGTH	53			SLAT LENGTH	45	
24		WALL HEIGHT	30			24		WALL HEIGHT	30			WALL HEIGHT	24	
43		PROJECTION	49.5			43		PROJECTION	49.5			PROJECTION	43	
17		POINT DROP	23			17		POINT DROP	23			POINT DROP	11	
Model	wt	WIDTH	Model	wt	WIDTH	Model	wt	WIDTH	Model	wt	WIDTH	Model	wt	WIDTH
D 4345	23	42 7/8	D 4353	25		DX 5045	29	50	DX 5053	31		DA 4345	23	42 7/8
D 4645	23	45 15/16	D 4653	25		DX 5245	30	52 1/2	DX 5253	32		DA 4645	23	45 15/16
D 4945	24	49	D 4953	26		DX 5545	31	55	DX 5553	33		DA 4945	24	49
D 5245	26	52 1/16	D 5253	28		DX 5745	32	57 1/2	DX 5753	34		DA 5245	26	52 1/16
D 5545	27	55 1/8	D 5553	29		DX 6045	33	60	DX 6053	35		DA 5545	27	55 1/8
D 5845	27	58 3/16	D 5853	29		DX 6245	34	62 1/2	DX 6253	36		DA 5845	27	58 3/16
D 6145	28	61 1/4	D 6153	31		DX 6545	35	65	DX 6553	37		DA 6145	28	61 1/4
D 6445	29	64 5/16	D 6453	32		DX 6745	36	67 1/2	DX 6753	38		DA 6445	29	64 5/16
D 6745	29	67 3/8	D 6753	32		DX 7045	37	70	DX 7053	39		DA 6745	29	67 3/8
D 7045	30	70 7/16	D 7053	33		DX 7245	38	72 1/2	DX 7253	40		DA 7045	30	70 7/16
D 7345	32	73 1/2	D 7353	34		DX 7545	39	75	DX 7553	41		DA 7345	32	73 1/2
D 7745	32	76 9/16	D 7753	34		DX 7745	40	77 1/2	DX 7753	42		DA 7745	32	76 9/16
D 8045	32	79 5/8	D 8053	35		DX 8045	41	80	DX 8053	43		DA 8045	32	79 5/8
D 8345	33	82 11/16	D 8353	36		DX 8245	42	82 1/2	DX 8253	44		DA 8345	33	82 11/16
D 8645	33	85 3/4	D 8653	36		DX 8545	43	85	DX 8553	45		DA 8645	33	85 3/4
D 8945	34	88 13/16	D 8953	38		DX 8745	44	87 1/2	DX 8753	46		DA 8945	34	88 13/16
D 9245	34	91 7/8	D 9253	38		DX 9045	45	90	DX 9053	47		DA 9245	34	91 7/8
D 9545	35	94 15/16	D 9553	39		DX 9245	46	92 1/2	DX 9253	48		DA 9545	35	94 15/16
D 9845	37	98	D 9853	41		DX 9545	47	95	DX 9553	49		DA 9845	37	98
D 10145	38	101 1/16	D 10153	42		DX 9745	48	97 1/2	DX 9753	49		DA 10145	38	101 1/16
D 10445	38	104 1/8	D 10453	42		DX 10045	48	100	DX 10053	50		DA 10445	38	104 1/8
D 10745	39	107 3/16	D 10753	43		DX 10245	49	102 1/2	DX 10253	51		DA 10745	39	107 3/16
D 11045	39	110 1/4	D 11053	43		DX 10545	49	105	DX 10553	51		DA 11045	39	110 1/4
D 11345	40	113 5/16	D 11353	44		DX 10745	50	107 1/2	DX 10753	52		DA 11345	40	113 5/16
D 11645	41	116 3/8	D 11653	45		DX 11045	50	110	DX 11053	52		DA 11645	41	116 3/8
D 11945	42	119 7/16	D 11953	46		DX 11245	51	112 1/2	DX 11253	53		DA 11945	42	119 7/16
D 12245	42	122 1/2	D 12253	47		DX 11545	51	115	DX 11553	53		DA 12245	42	122 1/2
D 12645	43	125 9/16	D 12653	48		DX 11745	52	117 1/2	DX 11753	54		DA 12645	43	125 9/16
D 12945	44	128 5/8	D 12953	49		DX 12045	52	120	DX 12053	54		DA 12945	44	128 5/8
D 13245	45	131 11/16	D 13253	50		DX 12245	53	122 1/2	DX 12253	55		DA 13245	45	131 11/16
D 13545	46	134 3/4	D 13553	52		DX 12545	55	125	DX 12553	57		DA 13545	46	134 3/4
D 13845	47	137 13/16	D 13853	54		DX 12745	56	127 1/2	DX 12753	58		DA 13845	47	137 13/16
Additional widths available in 3 1/16" Increments			Additional widths available in 3 1/16" Increments			Additional widths available in 2 1/2" Increments			Additional widths available in 2 1/2" Increments			Additional widths available in 3 1/16" Increments		

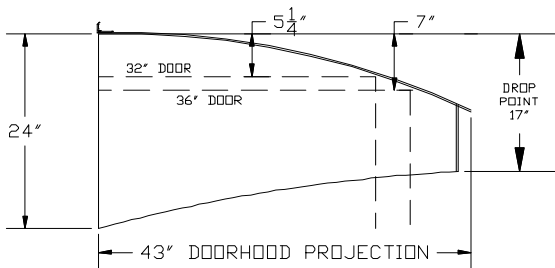

D or DX 45

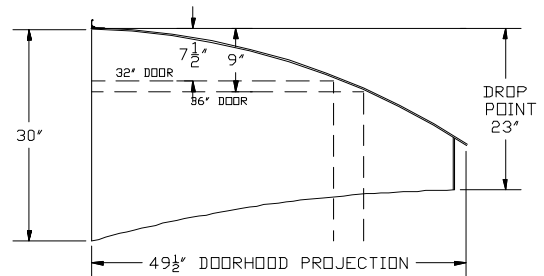

D or DX 53

DA.45 Doorhood utilizing 3 1/16" Dolphin Slats for a solid top awning

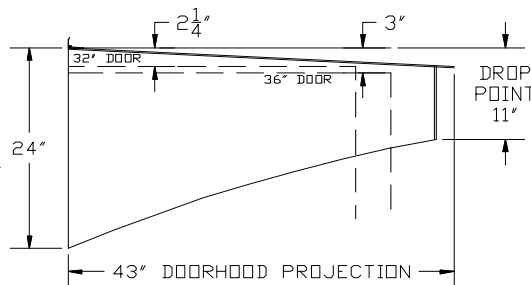

VENTILATED CONCAVE STYLES

BR - BS SERIES ALUMINUM AWNINGS

8/15/2009

	B_23		B_28		B_33		B_38		B_45		B_53		SLAT LENGTH
	R	S	R	S	R	S	R	S	R	S	R	S	
SLAT LENGTH	23	23	28	28	33	33	38	38	45	45	53	53	SLAT LENGTH
WALL HEIGHT	19	13	22	16	26	19	31	22	37	27	45	32	WALL HEIGHT
PROJECTION	14	19	16	24	21	27	23	32	26	37	28	43	PROJECTION
POINT DROP	19	13	22	16	26	19	31	22	37	27	45	32	POINT DROP
WIDTH													
29 3/4	B_3023	10	B_3028	11	B_3033	12	B_3038	15	B_3045	16	B_3053	26	
32 1/2	B_3323	10	B_3328	12	B_3333	12	B_3338	15	B_3345	17	B_3353	26	
35 1/4	B_3523	11	B_3528	12	B_3533	13	B_3538	16	B_3545	17	B_3553	27	
38	B_3823	12	B_3828	14	B_3833	14	B_3838	19	B_3845	20	B_3853	28	
40 3/4	B_4123	13	B_4128	14	B_4133	15	B_4138	19	B_4145	20	B_4153	29	
43 1/2	B_4423	13	B_4428	15	B_4433	16	B_4438	20	B_4445	21	B_4453	29	
46 1/4	B_4623	13	B_4628	15	B_4633	16	B_4638	20	B_4645	22	B_4653	30	
49	B_4923	14	B_4928	16	B_4933	17	B_4938	21	B_4945	22	B_4953	31	
51 3/4	B_5223	14	B_5228	16	B_5233	17	B_5238	21	B_5245	23	B_5253	32	
54 1/2	B_5523	18	B_5528	19	B_5533	19	B_5538	21	B_5545	25	B_5553	33	
57 1/4	B_5723	19	B_5728	19	B_5733	20	B_5738	25	B_5745	26	B_5753	33	
60	B_6023	19	B_6028	20	B_6033	20	B_6038	25	B_6045	26	B_6053	34	
62 3/4	B_6323	19	B_6328	20	B_6333	21	B_6338	26	B_6345	27	B_6353	35	
65 1/2	B_6623	20	B_6628	21	B_6633	22	B_6638	26	B_6645	28	B_6653	36	
68 1/4	B_6823	21	B_6828	22	B_6833	23	B_6838	27	B_6845	29	B_6853	37	
71	B_7123	22	B_7128	23	B_7133	24	B_7138	28	B_7145	30	B_7153	38	
Additional widths available in 2 3/4" Increments		Additional widths available in 2 3/4" Increments		Additional widths available in 2 3/4" Increments		Additional widths available in 2 3/4" Increments		Additional widths available in 2 3/4" Increments		Additional widths available in 2 3/4" Increments		Additional widths available in 2 3/4" Increments	

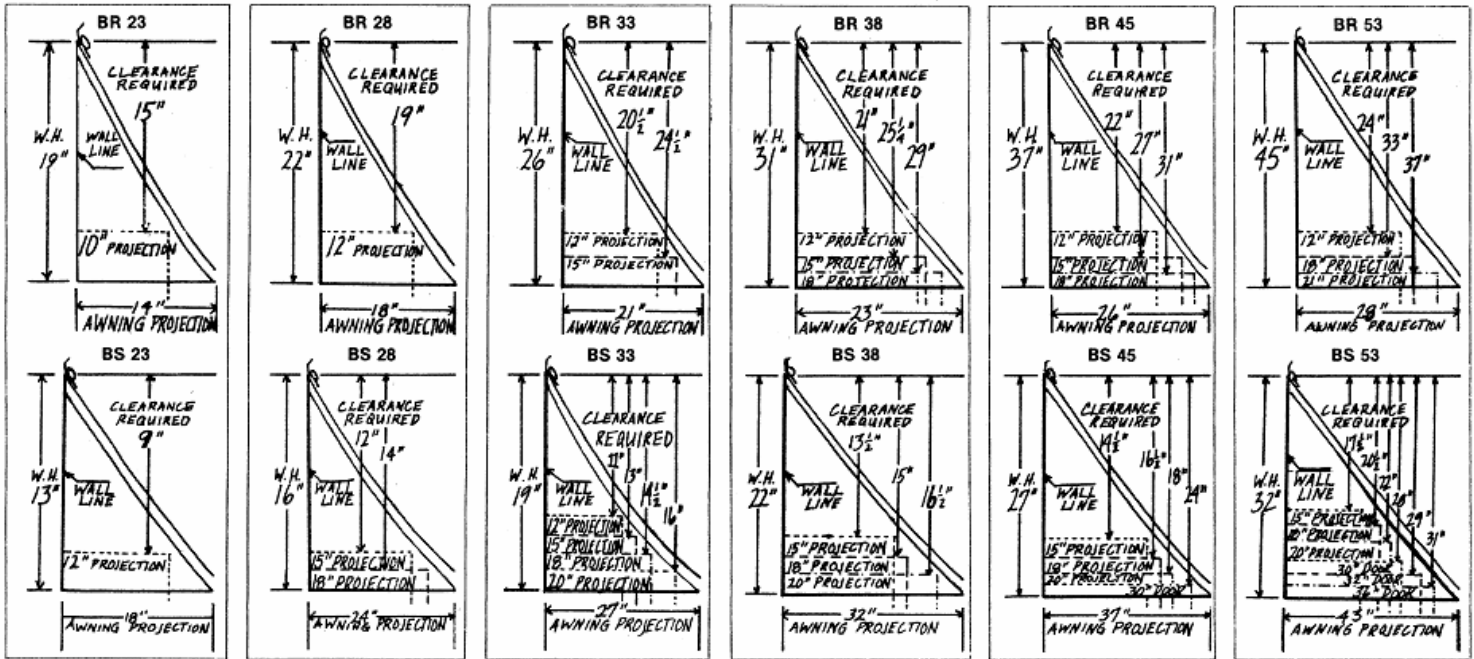

Max recommended window height 31"

Max recommended window height 39"

Max recommended window height 47"

Max recommended window height 55"

Max recommended window height 63"

Max recommended window height 71"

INCREMENTAL WIDTH CHART FOR VENTILATED AWNINGS [up to 230 1/2"]

To be used as a guide for pricing awnings beyond the above prices

71 or less	0	95 3/4	9	123 1/4	19	150 3/4	29	178 1/4	39	205 3/4	49
73 3/4	1	101 1/4	11	128 3/4	21	156 1/4	31	183 3/4	41	211 1/4	51
76 1/2	2	104	12	131 1/2	22	159	32	186 1/2	42	214	52
79 1/4	3	106 3/4	13	134 1/4	23	161 3/4	33	189 1/4	43	216 3/4	53
82	4	109 1/2	14	137	24	164 1/2	34	192	44	219 1/2	54
84 3/4	5	112 1/4	15	139 3/4	25	167 1/4	35	194 3/4	45	222 1/4	55
87 1/2	6	115	16	142 1/2	26	170	36	197 1/2	46	225	56
90 1/4	7	117 3/4	17	145 1/4	27	172 3/4	37	200 1/4	47	227 3/4	57
93	8	120 1/2	18	148	28	175 1/2	38	203	48	230 1/2	58

VENTILATED CONVEX STYLES

CR - CS SERIES ALUMINUM AWNINGS

8/15/2009

	C_23		C_28		C_33		C_38		C_45		C_53			
	R	S	R	S	R	S	R	S	R	S	R	S		
SLAT LENGTH	23	23	28	28	33	33	38	38	45	45	53	53		
WALL HEIGHT	20	15	23	18	27	21	32	25	38	29	49	32		
PROJECTION	17	19	21	23	24	27	25	32	30	38	31	46		
POINT DROP	16.5	14	19	17	23	19	28	22.5	32	24	43	26		
WIDTH	wt		wt		wt		wt		wt		wt			
29 3/4	C_3023	10	C_3028	11	C_3033	12	C_3038	15	C_3045	16	C_3053	26		
32 1/2	C_3323	10	C_3328	12	C_3333	12	C_3338	15	C_3345	17	C_3353	26		
35 1/4	C_3523	11	C_3528	12	C_3533	13	C_3538	16	C_3545	17	C_3553	27		
38	C_3823	12	C_3828	14	C_3833	14	C_3838	19	C_3845	20	C_3853	28		
40 3/4	C_4123	13	C_4128	14	C_4133	15	C_4138	19	C_4145	20	C_4153	29		
43 1/2	C_4423	13	C_4428	15	C_4433	16	C_4438	20	C_4445	21	C_4453	29		
46 1/4	C_4623	13	C_4628	15	C_4633	16	C_4638	20	C_4645	22	C_4653	30		
49	C_4923	14	C_4928	16	C_4933	17	C_4938	21	C_4945	22	C_4953	31		
51 3/4	C_5223	14	C_5228	16	C_5233	17	C_5238	21	C_5245	23	C_5253	32		
54 1/2	C_5523	18	C_5528	19	C_5533	19	C_5538	21	C_5545	25	C_5553	33		
57 1/4	C_5723	19	C_5728	19	C_5733	20	C_5738	25	C_5745	26	C_5753	33		
60	C_6023	19	C_6028	20	C_6033	20	C_6038	25	C_6045	26	C_6053	34		
62 3/4	C_6323	19	C_6328	20	C_6333	21	C_6338	26	C_6345	27	C_6353	35		
65 1/2	C_6623	20	C_6628	21	C_6633	21	C_6638	26	C_6645	28	C_6653	36		
68 1/4	C_6823	21	C_6828	22	C_6833	22	C_6838	27	C_6845	29	C_6853	37		
71	C_7123	22	C_7128	23	C_7133	23	C_7138	28	C_7145	30	C_7153	38		
Additional widths available in 2 3/4" Increments			Additional widths available in 2 3/4" Increments			Additional widths available in 2 3/4" Increments			Additional widths available in 2 3/4" Increments			Additional widths available in 2 3/4" Increments		

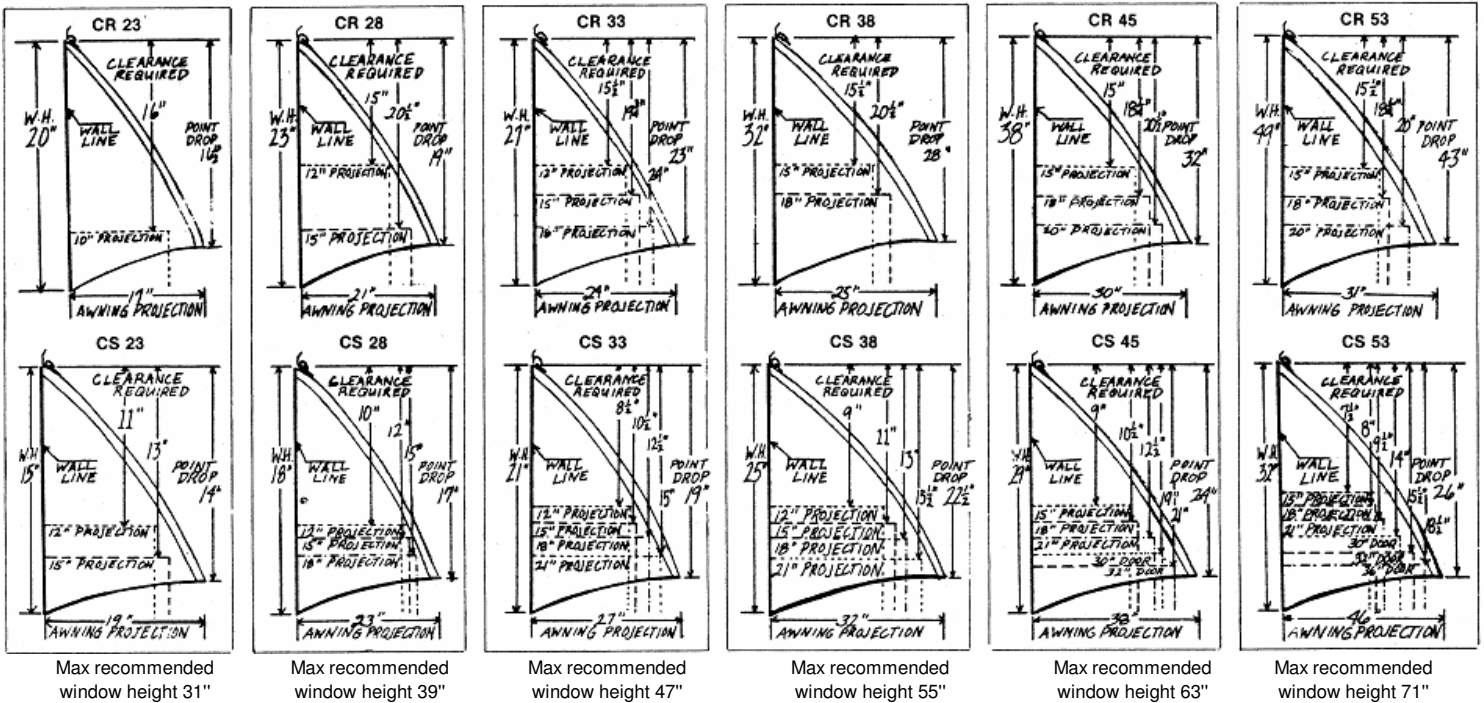

Max recommended window height 31"

Max recommended window height 39"

Max recommended window height 47"

Max recommended window height 55"

Max recommended window height 63"

Max recommended window height 71"

INCREMENTAL WIDTH CHART FOR VENTILATED AWNINGS [230 1/2" to 395 1/2"]

To be used as a guide for pricing awnings beyond the above prices

233 1/4	59	260 3/4	69	288 1/4	79	315 3/4	89	343 1/4	99	370 3/4	109
236	60	263 1/2	70	291	80	318 1/2	90	346	100	373 1/2	110
238 3/4	61	266 1/4	71	293 3/4	81	321 1/4	91	348 3/4	101	376 1/4	111
241 1/2	62	269	72	296 1/2	82	324	92	351 1/2	102	379	112
244 1/4	63	271 3/4	73	299 1/4	83	326 3/4	93	354 1/4	103	381 3/4	113
247	64	274 1/2	74	302	84	329 1/2	94	357	104	384 1/2	114
249 3/4	65	277 1/4	75	304 3/4	85	332 1/4	95	359 3/4	105	387 1/4	115
252 1/2	66	280	76	307 1/2	86	335	96	362 1/2	106	390	116
255 1/4	67	282 3/4	77	310 1/4	87	337 3/4	97	365 1/4	107	392 3/4	117
258	68	285 1/2	78	313	88	340 1/2	98	368	108	395 1/2	118

VENTILATED CONCAVE VALANCE STYLES

BVR - BVS SERIES ALUMINUM AWNINGS

8/15/2009

	BV 23			BV 28			BV 33			BV 38			BV 45			BV 53		
	R	S		R	S		R	S		R	S		R	S		R	S	
SLAT LENGTH	23	23		28	28		33	33		38	38		45	45		53	53	
WALL HEIGHT	22"	18"		27"	21"		31"	24"		36	29		42	31		48	41	
PROJECTION	18"	22"		22"	26"		26"	31"		29.5	35		35	42		42.5	49	
POINT DROP	21"	15"		24"	18"		27 1/2"	20"		31	23		35	23		39.5	28	
WIDTH			wt			wt			wt			wt			wt			wt
29 3/4	BV_3023		10	BV_3028		11#	BV_3033		12	BV_3038		15	BV_3045		16	BV_3053		26
32 1/2	BV_3323		10	BV_3328		12#	BV_3333		12	BV_3338		15	BV_3345		17	BV_3353		26
35 1/4	BV_3523		11	BV_3528		12#	BV_3533		13	BV_3538		16	BV_3545		17	BV_3553		27
38	BV_3823		12	BV_3828		14#	BV_3833		14	BV_3838		19	BV_3845		20	BV_3853		28
40 3/4	BV_4123		13	BV_4128		14#	BV_4133		15	BV_4138		19	BV_4145		20	BV_4153		29
43 1/2	BV_4423		13	BV_4428		15#	BV_4433		16	BV_4438		20	BV_4445		21	BV_4453		29
46 1/4	BV_4623		13	BV_4628		15#	BV_4633		16	BV_4638		20	BV_4645		22	BV_4653		30
49	BV_4923		14	BV_4928		16#	BV_4933		17	BV_4938		21	BV_4945		22	BV_4953		31
51 3/4	BV_5223		14	BV_5228		16#	BV_5233		17	BV_5238		21	BV_5245		23	BV_5253		32
54 1/2	BV_5523		18	BV_5528		19#	BV_5533		19	BV_5538		21	BV_5545		25	BV_5553		33
57 1/4	BV_5723		19	BV_5728		19#	BV_5733		20	BV_5738		25	BV_5745		26	BV_5753		33
60	BV_6023		19	BV_6028		20#	BV_6033		20	BV_6038		25	BV_6045		26	BV_6053		34
62 3/4	BV_6323		19	BV_6328		20#	BV_6333		21	BV_6338		26	BV_6345		27	BV_6353		35
65 1/2	BV_6623		20	BV_6628		21#	BV_6633		21	BV_6638		26	BV_6645		28	BV_6653		36
68 1/4	BV_6823		21	BV_6828		22#	BV_6833		22	BV_6838		27	BV_6845		29	BV_6853		37
71	BV_7123		22	BV_7128		23#	BV_7133		23	BV_7138		28	BV_7145		30	BV_7153		38
	Additional widths available in 2 3/4" Increments			Additional widths available in 2 3/4" Increments			Additional widths available in 2 3/4" Increments			Additional widths available in 2 3/4" Increments			Additional widths available in 2 3/4" Increments			Additional widths available in 2 3/4" Increments		

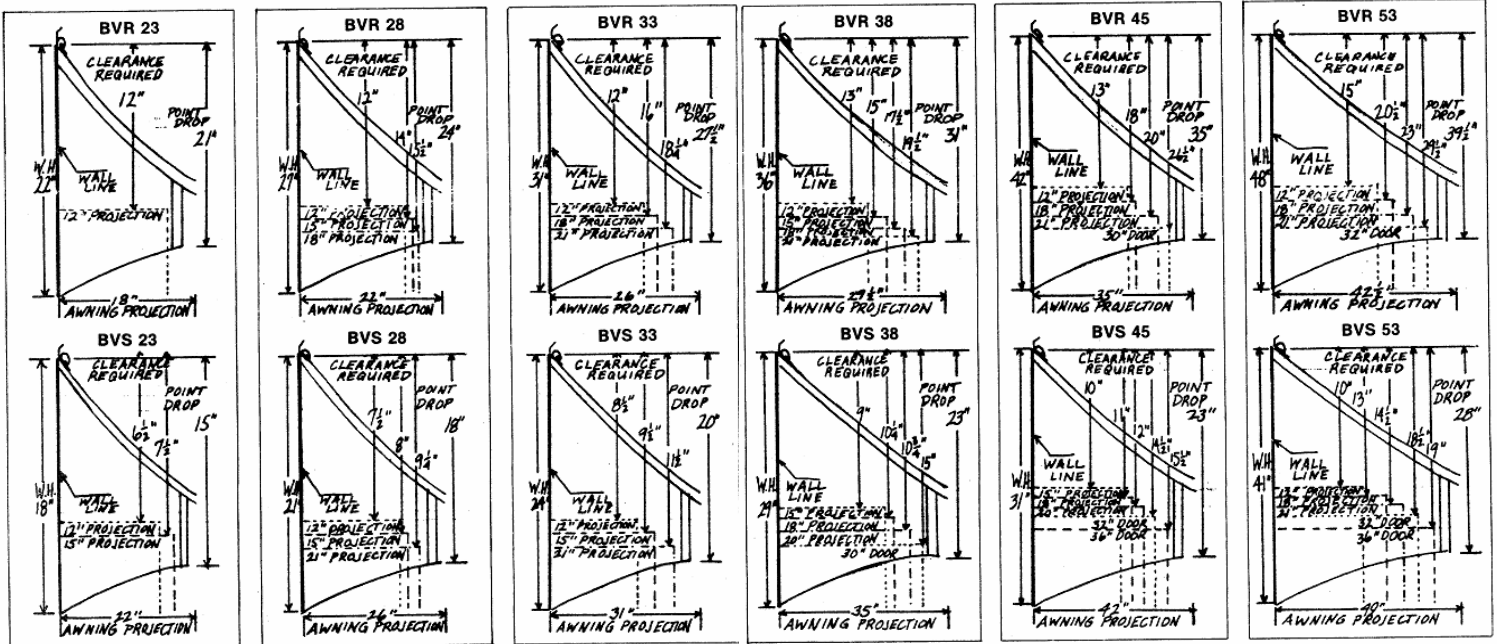

Max recommended window height 31"

Max recommended window height 39"

Max recommended window height 47"

Max recommended window height 55"

Max recommended window height 63"

Max recommended window height 71"

INCREMENTAL WIDTH CHART FOR VENTILATED AWNINGS [up to 230 1/2"]

To be used as a guide for pricing awnings beyond the above prices

71 or less	0	95 3/4	9	123 1/4	19	150 3/4	29	178 1/4	39	205 3/4	49
73 3/4	1	101 1/4	11	128 3/4	21	156 1/4	31	183 3/4	41	211 1/4	51
76 1/2	2	104	12	131 1/2	22	159	32	186 1/2	42	214	52
79 1/4	3	106 3/4	13	134 1/4	23	161 3/4	33	189 1/4	43	216 3/4	53
82	4	109 1/2	14	137	24	164 1/2	34	192	44	219 1/2	54
84 3/4	5	112 1/4	15	139 3/4	25	167 1/4	35	194 3/4	45	222 1/4	55
87 1/2	6	115	16	142 1/2	26	170	36	197 1/2	46	225	56
90 1/4	7	117 3/4	17	145 1/4	27	172 3/4	37	200 1/4	47	227 3/4	57
93	8	120 1/2	18	148	28	175 1/2	38	203	48	230 1/2	58

VENTILATED CONVEX VALANCE STYLES

CVR - CVS SERIES ALUMINUM AWNINGS

8/15/2009

	CV 23		CV 28		CV 33		CV 38		CV 45		CV 53		SLAT LENGTH	
	R	S	R	S	R	S	R	S	R	S	R	S		
SLAT LENGTH	23	23	28	28	33	33	38	38	45	45	53	53	SLAT LENGTH	
WALL HEIGHT	24"	21"	26"	21"	33"	24"	33"	29"	38"	31"	46"	40 7/8"	WALL HEIGHT	
PROJECTION	15"	19"	21 1/2"	26"	23"	30"	30"	34"	37"	40 1/2"	41 1/2"	46 3/4"	PROJECTION	
POINT DROP	23"	17 1/2"	24"	18"	29"	20"	28"	23"	31"	25 1/2"	38 1/2"	28"	POINT DROP	
WIDTH			wt		wt		wt		wt		wt		wt	
29 3/4	CV_3023	10	CV_3028	11	CV_3033	12	CV_3038	15	CV_3045	16	CV_3053	26		
32 1/2	CV_3323	10	CV_3328	12	CV_3333	12	CV_3338	15	CV_3345	17	CV_3353	26		
35 1/4	CV_3523	11	CV_3528	12	CV_3533	13	CV_3538	16	CV_3545	17	CV_3553	27		
38	CV_3823	12	CV_3828	14	CV_3833	14	CV_3838	19	CV_3845	20	CV_3853	28		
40 3/4	CV_4123	13	CV_4128	14	CV_4133	15	CV_4138	19	CV_4145	20	CV_4153	29		
43 1/2	CV_4423	13	CV_4428	15	CV_4433	16	CV_4438	20	CV_4445	21	CV_4453	29		
46 1/4	CV_4623	13	CV_4628	15	CV_4633	16	CV_4638	20	CV_4645	22	CV_4653	30		
49	CV_4923	14	CV_4928	16	CV_4933	17	CV_4938	21	CV_4945	22	CV_4953	31		
51 3/4	CV_5223	14	CV_5228	16	CV_5233	17	CV_5238	21	CV_5245	23	CV_5253	32		
54 1/2	CV_5523	18	CV_5528	19	CV_5533	19	CV_5538	23	CV_5545	25	CV_5553	33		
57 1/4	CV_5723	19	CV_5728	19	CV_5733	20	CV_5738	25	CV_5745	26	CV_5753	33		
60	CV_6023	19	CV_6028	20	CV_6033	20	CV_6038	25	CV_6045	26	CV_6053	34		
62 3/4	CV_6323	19	CV_6328	20	CV_6333	21	CV_6338	26	CV_6345	27	CV_6353	35		
65 1/2	CV_6623	20	CV_6628	21	CV_6633	21	CV_6638	26	CV_6645	28	CV_6653	36		
68 1/4	CV_6823	21	CV_6828	22	CV_6833	22	CV_6838	27	CV_6845	29	CV_6853	37		
71	CV_7123	22	CV_7128	23	CV_7133	23	CV_7138	28	CV_7145	30	CV_7153	38		
Additional widths available in 2 3/4" Increments			Additional widths available in 2 3/4" Increments			Additional widths available in 2 3/4" Increments			Additional widths available in 2 3/4" Increments			Additional widths available in 2 3/4" Increments		

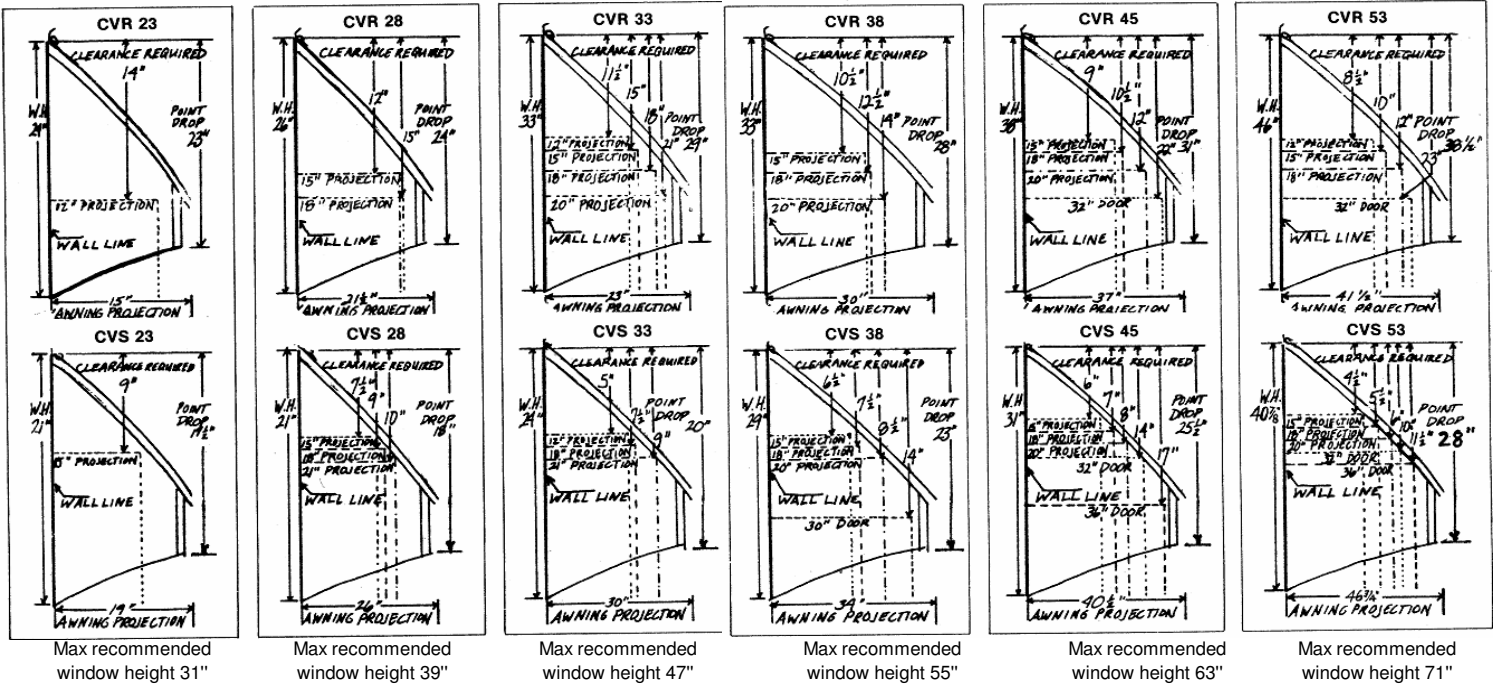

INCREMENTAL WIDTH CHART FOR VENTILATED AWNINGS [230 1/2" to 395 1/2"]

To be used as a guide for pricing awnings beyond the above prices

233 1/4	59	260 3/4	69	288 1/4	79	315 3/4	89	343 1/4	99	370 3/4	109
236	60	263 1/2	70	291	80	318 1/2	90	346	100	373 1/2	110
238 3/4	61	266 1/4	71	293 3/4	81	321 1/4	91	348 3/4	101	376 1/4	111
241 1/2	62	269	72	296 1/2	82	324	92	351 1/2	102	379	112
244 1/4	63	271 3/4	73	299 1/4	83	326 3/4	93	354 1/4	103	381 3/4	113
247	64	274 1/2	74	302	84	329 1/2	94	357	104	384 1/2	114
249 3/4	65	277 1/4	75	304 3/4	85	332 1/4	95	359 3/4	105	387 1/4	115
252 1/2	66	280	76	307 1/2	86	335	96	362 1/2	106	390	116
255 1/4	67	282 3/4	77	310 1/4	87	337 3/4	97	365 1/4	107	392 3/4	117
258	68	285 1/2	78	313	88	340 1/2	98	368	108	395 1/2	118

Fashion

1019 North St
Ottawa, KS 66067
800.255.1009
Fax 785.242.2022

DEALER NAME : _____

ADDRESS : _____

CITY, ST : _____

CUSTOMER NAME: _____

LOCATION : _____

ORDER DATE

PURCHASE ORDER #

JOB #

SHIP VIA

EXAMPLE ORDER

2	BVR	63	33	IVORY	P-2	BRICK RED
QTY	STYLE	WIDTH	SLAT LENGTH	COLOR	OPTIONAL TRIM SLATS & COLOR	

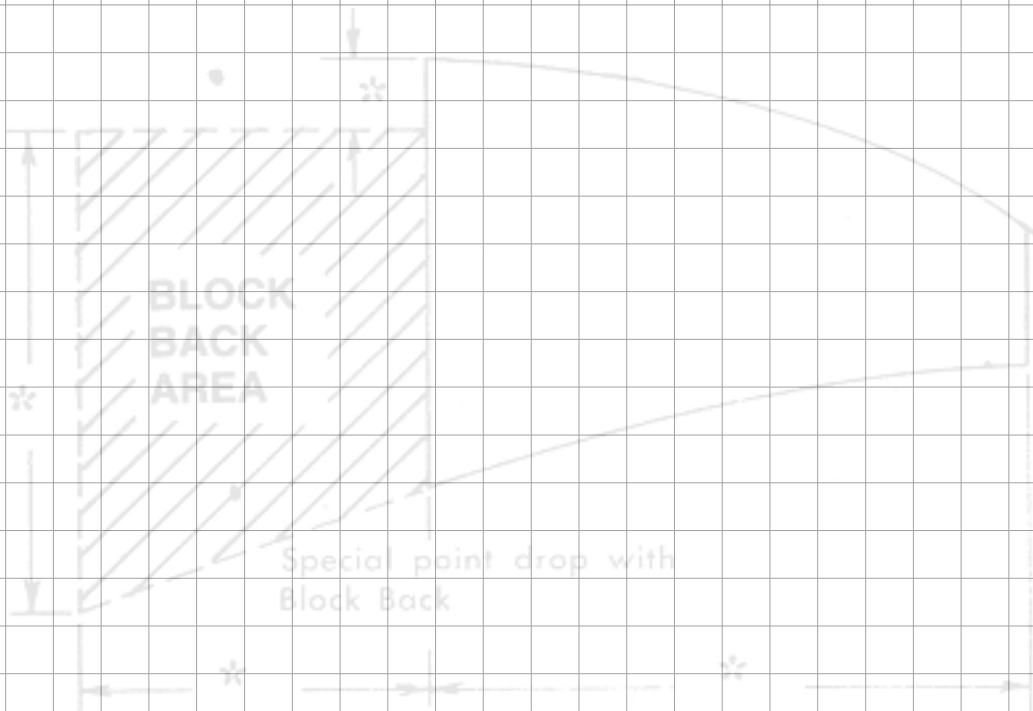

INSTALLATION INSTRUCTIONS

FASHION VENTILATED AWNINGS AND DOORHOODS

HOW TO INSTALL AWNING

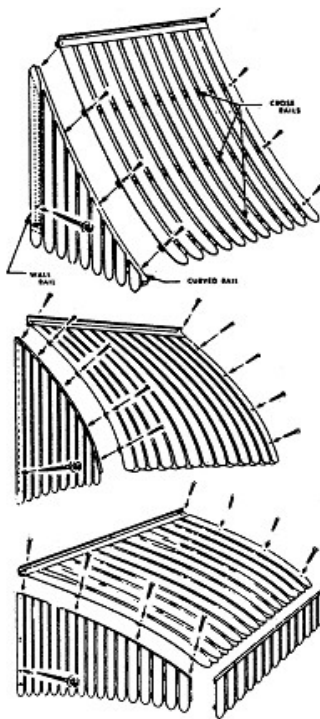

1. WITH THE END SECTIONS IN A VERTICAL POSITION, HOLD TOP SECTION IN PLACE WITH THE CROSS RAIL ENDS RESTING ON TOP OF THE CURVED RAIL.
2. ALIGN THE SCREW HOLES THAT HAVE BEEN PRE-DRILLED THROUGH THE TOP CROSS RAIL OVER THE CURVED RAILS OF THE END SECTIONS AND DRILL OR PUNCH HOLES TO DRIVE #8 X 1 1/4" S.M. SCREWS THROUGH TO CONNECT END SECTION TO THE TOP SECTION.
3. TO INSTALL: CENTER THE FEMALE HANGER AT THE DESIRED HEIGHT OVER THE WINDOW WITH HANGER LEVEL. DRIVE #8 X 1 1/4" S.M. SCREWS THROUGH THE HOLES IN HANGER INTO WALL. INSERT MALE HANGER INTO FEMALE HANGER SECTION. LOWER AWNING UNTIL IT LOCKS INTO POSITION, SEE FIGURE NO. 2
4. ADJUST THE END SECTIONS PARALLEL TO THE WINDOW FACING AND DRIVE #10 X 2" S.M. SCREWS THROUGH THE HOLE IN EACH WALL RAIL. CAULK TOP EDGE OF FEMALE HANGER.

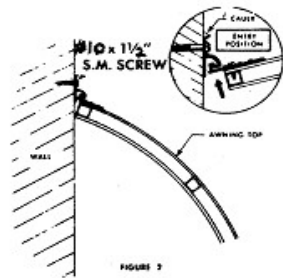
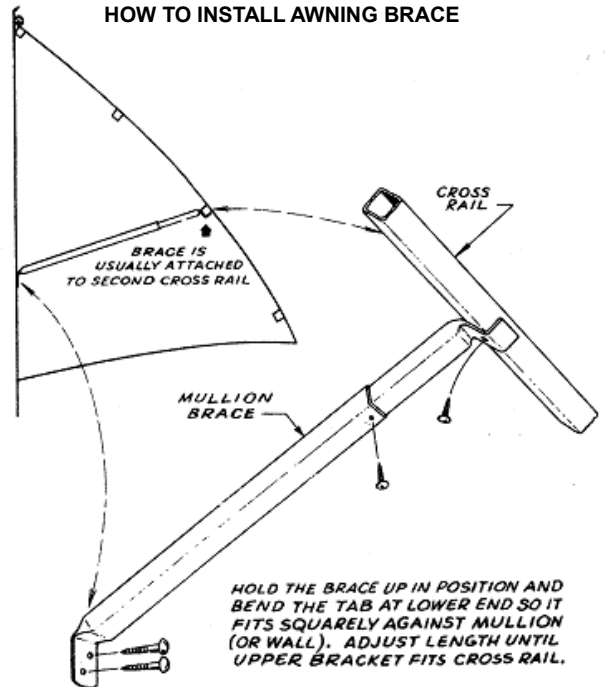

FIGURE 1

FIGURE 2

HOW TO INSTALL AWNING BRACE



HOLD THE BRACE UP IN POSITION AND BEND THE TAB AT LOWER END SO IT FITS SQUARELY AGAINST MULLION (OR WALL). ADJUST LENGTH UNTIL UPPER BRACKET FITS CROSS RAIL.

ATTACH TAB TO MULLION (OR TO WALL) WITH 2 #10 X 1 1/2", OR LARGER SCREWS. BRACKET ATTACHES TO CROSS RAIL WITH A #8 X 1/2" TEC METAL SCREW.

THE LENGTH ADJUSTMENT IS FASTENED WITH A #6 X 3/8" S.M. SCREW THROUGH ONE OF THE 5 HOLES PROVIDED.

INSTALLING THE VALANCE

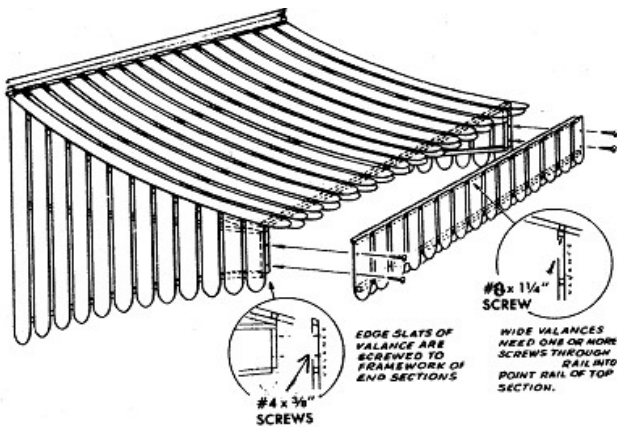

EDGE SLATS OF VALANCE ARE SCREWED TO FRAMEWORK OF END SECTIONS

#4 X 3/8" SCREWS

WIDE VALANCES NEED ONE OR MORE SCREWS THROUGH RAIL INTO POINT RAIL OF TOP SECTION.

#8 X 1 1/4" SCREW

INSTALLING THE VALANCE BRACE

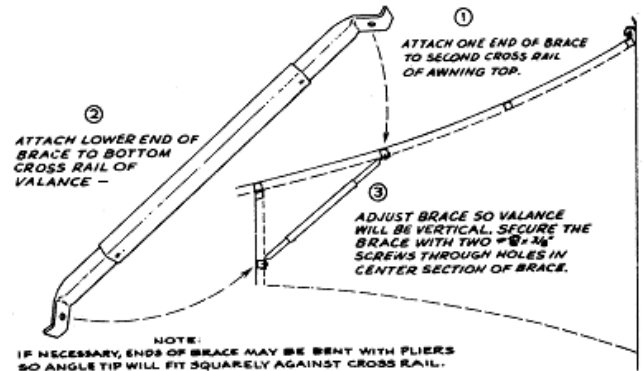

NOTE: IF NECESSARY, ENDS OF BRACE MAY BE BENT WITH PLIERS SO ANGLE TIP WILL FIT SQUARELY AGAINST CROSS RAIL.

HOW TO INSTALL THE HAT SECTION

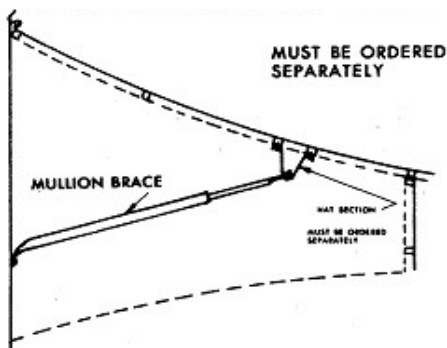

MUST BE ORDERED SEPARATELY

MULLION BRACE

HAT SECTION

MUST BE ORDERED SEPARATELY

HOW TO SPLICE AWNINGS

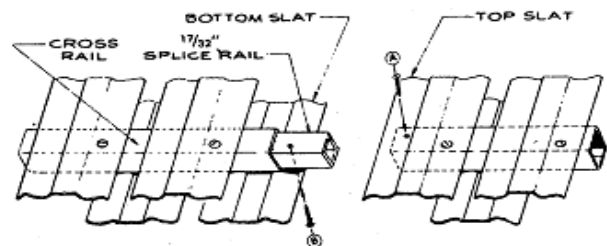

INSERT SPLICE RAILS INTO CORRESPONDING CROSS RAILS OF RIGHT TOP SECTION. SECURE EACH JOINT WITH A #4 X 3/8" SCREW THROUGH TOP SLAT AT "A". THIS SCREW PENETRATES SLAT, CROSS RAIL AND 17/32" SPLICE RAIL. A SIMILAR SCREW THROUGH BOTTOM SLAT AT "B" STRENGTHENS THE JOINT.

NOTE: VALANCES ARE SPLICED IN THE SAME MANNER.

ON EXTRA WIDE INSTALLATIONS IT MAY BE NECESSARY TO USE (STEEL) HAT SECTIONS IF YOU ARE UNABLE TO USE THE STANDARD MULLIONS SHIPPED WITH THE AWNING. EACH SPLICED VERTICAL AWNING WILL HAVE AN EXTRA CROSS RAIL IN THE TOP SECTION. THE HAT SECTION IS ATTACHED TO THE DOUBLE CROSS RAILS APPROXIMATELY EVERY 12" O.C. THE MULLION BRACES WITH A MAXIMUM SPACING OF TEN FEET ARE THEN ATTACHED TO THE HAT SECTION.

Fashion

ADDITIONAL INFORMATION MAY BE OBTAINED ONLINE AT

www.fashioninc.com

email sales@fashioninc.com

or by contacting

Fashion, Inc.
1019 North St
PO Box 1050
Ottawa, KS 66067
800.255.1009
fax 785.242.2022